



# Agenda for our 6<sup>th</sup> AGM

## 1. Welcome

2. Approve Minutes of AGM for Year 5.
3. Matters arising from Minutes of Year 5's AGM
4. Celebrating Year Six in the Life of the Partnership.
5. Annual Report and Accounts for the Period ending 31<sup>st</sup> March 2017
6. Election of Directors to serve on the Board for up to three years.
7. Appointment of Independent Examiner for the 2017-18 financial year.
8. Any other relevant business or questions
9. Official opening of the garden renovation.



# Ground floor room usage

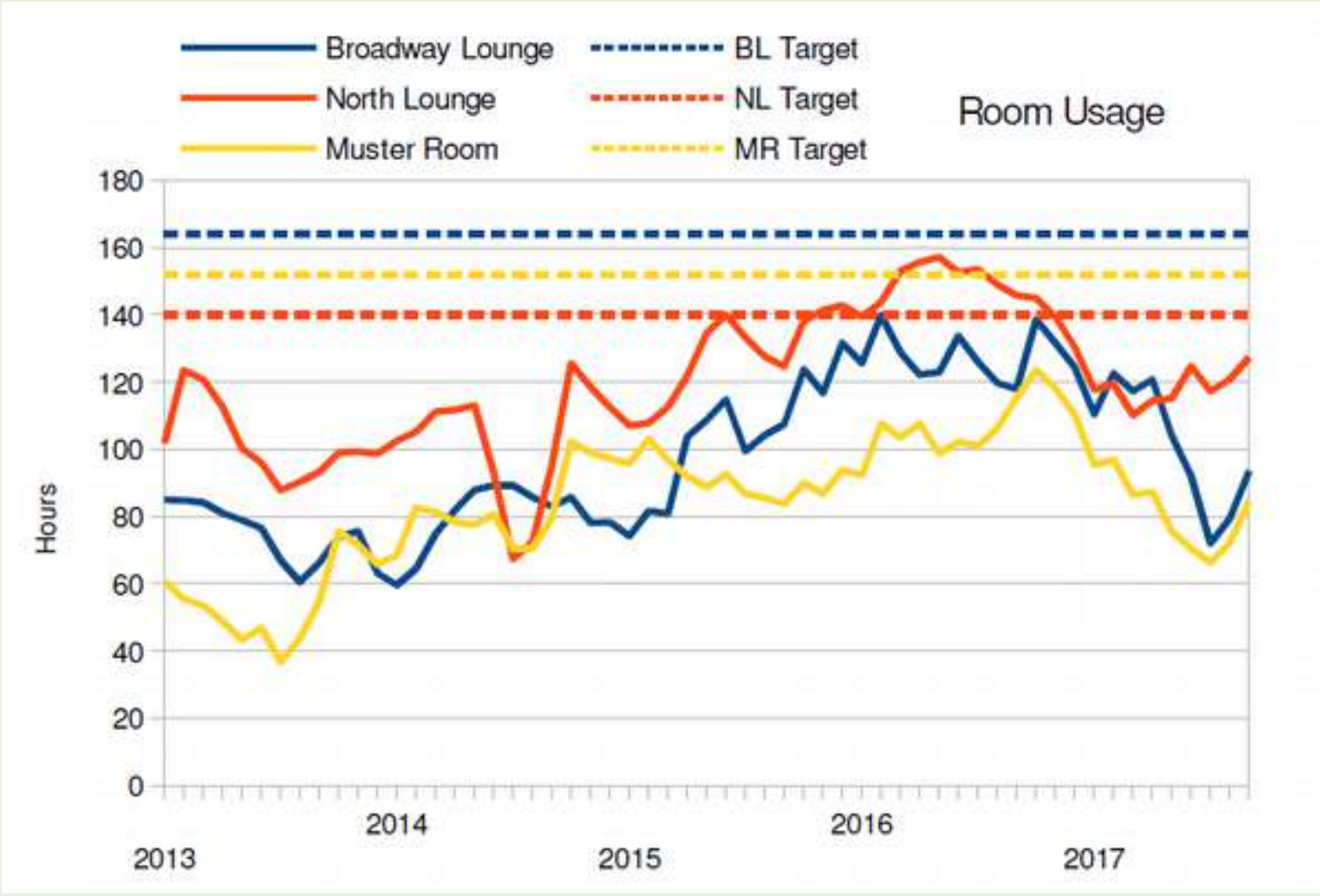



# Other room usage

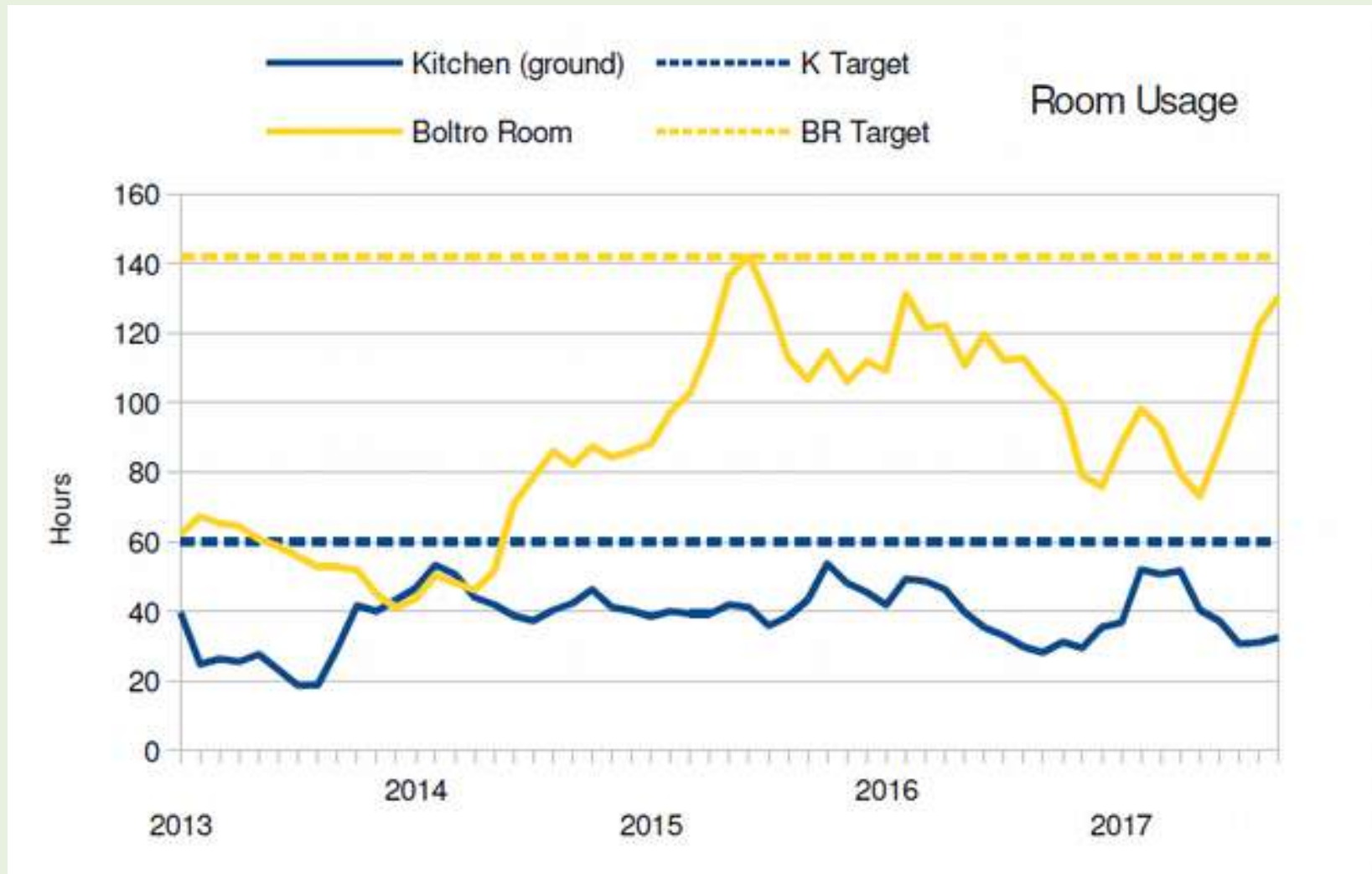



**The Yews ( Haywards Heath) Community Partnership  
SUMMARY INCOME STATEMENT**

	Year ended		
	Mar-31 2017	Mar-31 2016	Mar-31 2015
<b>Income</b>			
Room Hire	43,757	42,110	29,845
Grants & Donations	13,295	14,451	29,756
Fund raising	1,978	606	1,340
<b>TOTAL INCOME</b>	<b>59,030</b>	<b>57,167</b>	<b>60,941</b>
Running costs	46,243	46,404	41,713
Surplus/Shortfall in Running costs	12,787	10,763	19,228
Structural Projects & repairs	8,132	9,157	3,188
Transfers to & from reserves	-1,815	628	0
<b>Surplus for Year</b>	<b>6,470</b>	<b>978</b>	<b>16,040</b>



**The Yews (Haywards Heath) Community Partnership  
SUMMARY BALANCE SHEET**

	Mar-31 2017	Mar-31 2016	Mar-31 2015
<b>Current Assets</b>			
Debtors	8,903	8,793	7,588
Cash	36,711	32,998	30,854
<b>TOTAL CURRENT ASSETS</b>	<b>45,614</b>	<b>41,791</b>	<b>38,442</b>
Creditors and accruals	3,390	2,510	814
<b>Net Assets</b>	<b>42,224</b>	<b>39,281</b>	<b>37,628</b>
<b>Represented By</b>			
<b>Restricted Funds</b>			
Albemarle Little Builders	0	1,713	1,713
<b>Unrestricted Funds</b>			
General fund	29,803	23,332	22,353
Capital Spending reserve	2,477	4,900	4,300
Advance room Hire	944	836	762
General Reserve	9,000	8,500	8,500
<b>Sub total Unrestricted funds</b>	<b>42,224</b>	<b>37,568</b>	<b>35,915</b>
<b>Total Funds</b>	<b>42,224</b>	<b>39,281</b>	<b>37,628</b>



## Income Analysis v running costs

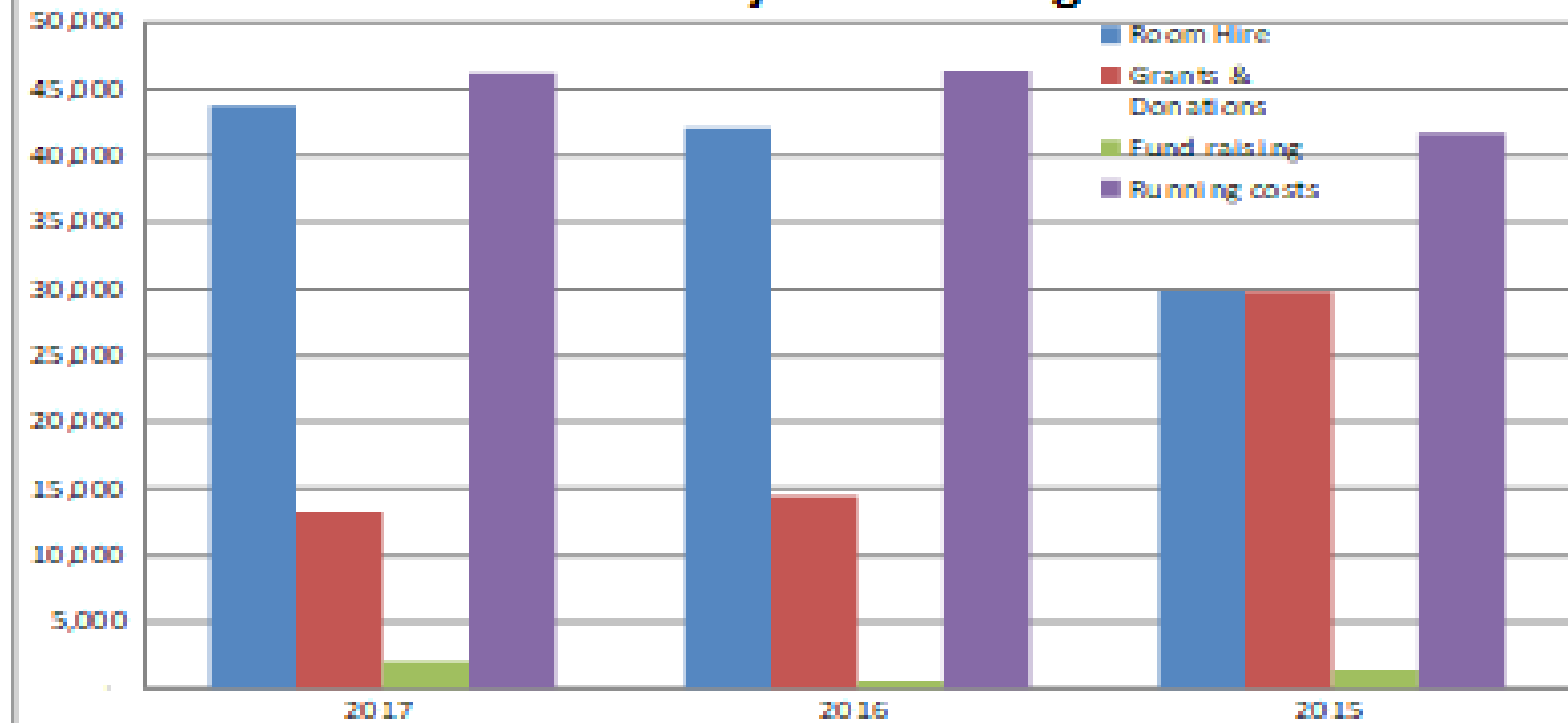



### 2016-17 Revenue by type



### 2016-17 Revenue by Client type



# Item 9 Garden Renovation







# Enjoying the garden





# Requirements

Survey of users identified need for:

- Tidy up
- More storage for equipment
- Relaxing area with separate access
- Improved all-weather grass area



# Plan

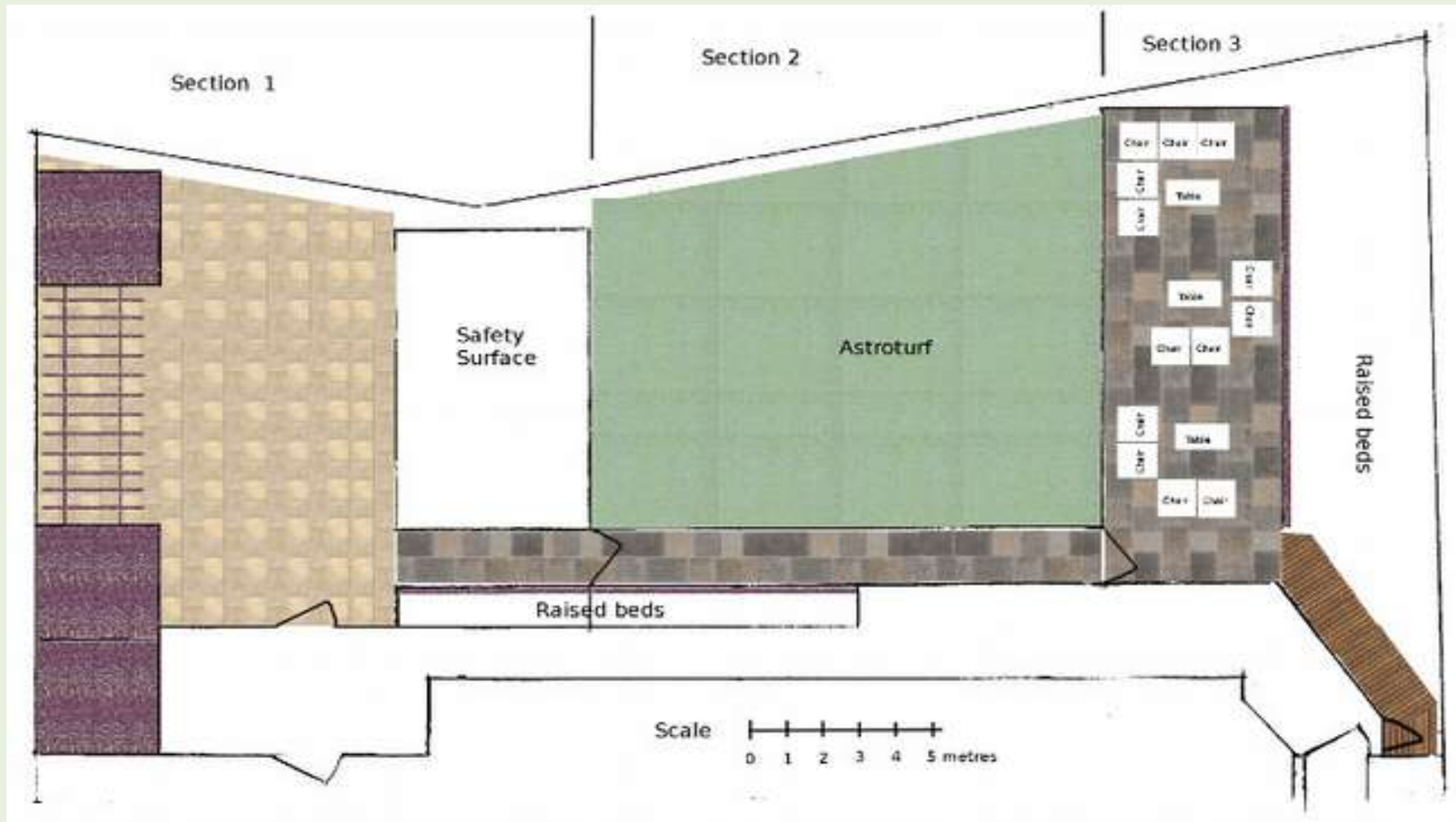

# Work underway



# New sheds



- Replace rotting shed

- More storage



# New facilities

- Easier access



- Somewhere to play



- Somewhere to relax



# Garden Plaque

**Garden Refurbishment**

**Funded by a grant from**

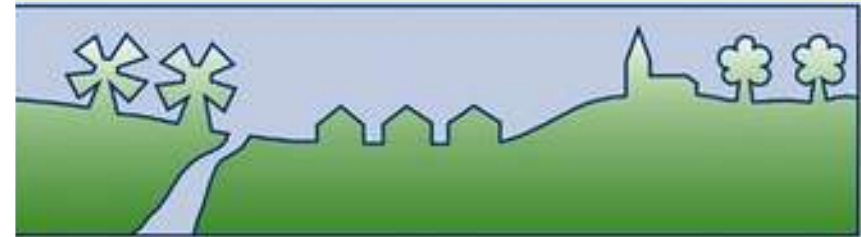

**MID SUSSEX**  
**DISTRICT COUNCIL**

**Opened on October 18<sup>th</sup> 2017**

**by Councillor Bruce Forbes,**

**Chairman, Mid Sussex District Council**